

2. Right click the Phone Manager icon in the system tray, goto "Softphone Setting", select "X-Pro/X-Lite mode". Restart Phone Manager
3. Right click the X-Lite/X-Pro application, enter "Audio Tuning wizard..." and make sure the USB Phone is selected for Audio in/out.

## USB VoIP Phone VOB 200

### Quick Installation Guide

#### Hardware Installation

Connect the USB connector of the USB phone to your computer's USB port. When connected to your computer, Windows will automatically detect the new device. Complete the driver installation according to your Windows operation system.

For Windows XP/2000

Under Windows XP/2000, you don't need to install the driver. The system will automatically install Windows built-in audio driver. After that, you are ready to use the USB phone.

For Windows Me/ Windows 98SE

When the Add New Hardware Wizard screen pops up, select Automatic search for a better driver and then click Finish to complete the Windows built-in driver installation.

#### Keypads and Control Buttons

\*Key definition for X-Lite/X-Pro mode is described in [ ]



## Application Installation

To use Skype/X-Lite/X-Pro with the USB phone in Windows 2000/XP, Skype/X-Lite/X-Pro is needed to be installed first. Refer to User's Manual for Skype/X-Lite/X-Pro Installation.

If you are using the USB phone simply as an audio input/output device in combination with an instant communication software, e.g., Google Talk, NetMeeting, MSN Messenger or Yahoo Messenger), you don't need to install any other software. Please ignore this chapter.

### Installing the Phone Manager

Phone Manager is a tool that enables your USB phone to communicate with softphones like Skype and X-Lite.

1. Insert the provided Software Utility CD into your CD-ROM drive. Setup program should run automatically.
2. Follow the on-screen prompts to proceed with the installation. Phone Manager would run automatically after installation.
3. For Skype User, Select Allow this program to use Skype and click OK.

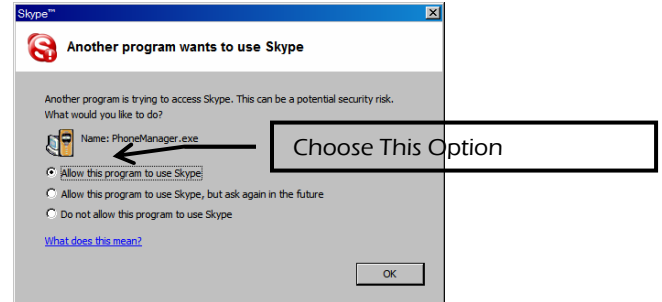

4. When the Phone Manager is launched, its icon will be displayed in the system tray. You can right click the icon to configure the manager.

### Using the USB Phone with Skype

When the USB phone is connected to a powered on computer, the device will start to connect to the installed Phone Manager. When the Phone Manager is successfully connected the phone to the service provider, like Skype, the Phone Manager icon in the system tray will be changed, indicating the device is ready for use.

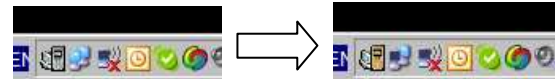

### Using the USB Phone with X-Lite/X-Pro/Eyeball

1. Start your X-Lite/X-Pro/Eyeball application